

**PENNSYLVANIA HISTORIC RESOURCE SURVEY FORM – PHOTO/SITE PLAN SHEET**  
**Pennsylvania Historic and Museum Commission, Bureau of Historic Preservation**  
**Commonwealth Keystone Building, 2<sup>nd</sup> Floor, 400 North Street, Harrisburg, PA 17108-1026**

Survey Code / HR #:	66-091a, b, c,& d, 66-151, & 66-152	Historic / Other Name:	West Chester & Philadelphia Railroad
Tax Parcel #	66-2-17-E; 66-2-27-E; 66-2-57-E	Address:	N/A
County:	Chester 029	Municipality:	Thornbury Township

**West Chester & Philadelphia Railroad**

**Photographs**

Photo 1: South & East (front) Elevations, Westtown Train Station with railroad tracks

**Photographer:**

J. Christopher Lang

**Date:** 4/19/2007

**Negative Location:**

Thornbury Township



**Location Map**

Thornbury Township  
 Historic Resource  
 Inventory GIS Map

**LOOK FOR: HR  
 #091a, 091b, 091c, 091d,  
 151 & 152**

**MAP KEY**

091a = HR Number  
 151 = HR Number  
 Purple = Class 1  
 Pink = Class 2  
 Yellow = Class 3  
 Med. Grey = Class 4

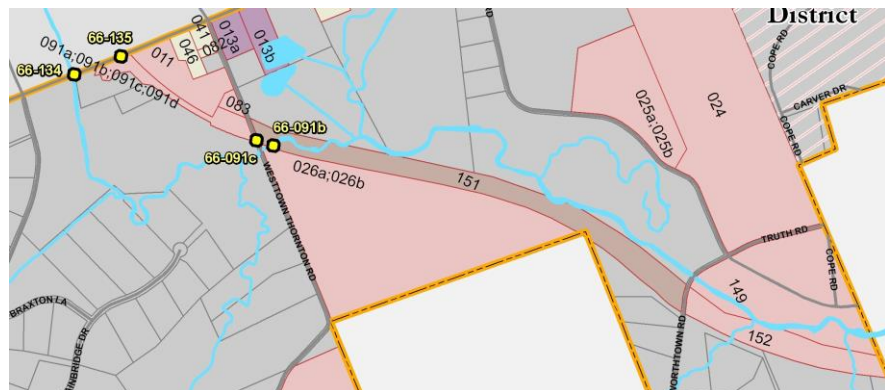

**PENNSYLVANIA HISTORIC RESOURCE SURVEY FORM – DATA SHEET**

Pennsylvania Historical and Museum Commission, Bureau for Historic Preservation

<b>IDENTIFICATION AND LOCATION</b>					
Survey Code/HR #	66-091a, -091b, 091c, -091d, 66-151, & 66-152	Tax Parcel No.	66-2-17-E; 66-2-27-E; 66-2-57-E		
County	1. Chester 029	2.			
Municipality	1. Thornbury Township	2.			
Address	N/A				
Historic Name	West Chester & Philadelphia Railroad				
Other Name					
Owner Name / Address					
Owner Category	Private	X Public – local	Public – state	Public – Federal	
Resource Category	Building	X District	Site	Structure	Object
Number/Approximate Number of Resources Covered by This Form	7				
USGS Quad	1. West Chester		2.		
UTM References	A.	B.	C.	D.	

<b>HISTORIC AND CURRENT FUNCTIONS</b>			
Historic Function Category		Subcategory	Code
A.	Transportation	Rail-related	16 A
B.	Transportation	Rail-related	16 A
C.	Transportation	Rail-related	16 A
D.			
Particular Type	A.	Train Station	
	B.	Railroad Bridge	
	C.	Railroad	
	D.		
Current Function Category		Subcategory	Code
A.	Recreation and Culture	Art Gallery	08
B.	Transportation	Rail-related	16 A
C.	Transportation	Rail-related	16 A
D.			

<b>PHYSICAL DESCRIPTION</b>					
Architectural Classification	A. No Style		B.		C.
	D.		Other:		
Exterior Materials	Foundation	Stone 50		Roof	Asphalt 63
	Walls	Stone 50		Walls	Wood 20
	Other	Metal 50		Other	
Structural System	1. N/A			2.	
Width 4 Bays D	Depth 2 Rooms B			Stories / Height 2.5 B	

**PENNSYLVANIA HISTORIC RESOURCE SURVEY FORM – NARRATIVE SHEET**

89C

Pennsylvania Historical and Museum Commission, Bureau for Historic Preservation

Survey Code/Historic Resource #66-091a, -091b, 091c, -091d, 66-151, &amp; 66-152 / West Chester &amp; Philadelphia Railroad / Thornbury Township, Chester County

**HISTORICAL INFORMATION**Year Built: X c. 1860 Additions/Alterations Dates:Basis for Dating: X Documentary \_\_\_ Physical

Explain: The West Chester and Philadelphia Railroad was founded in the 1850s, the track through Thornbury Township was laid by 1858 and the train station was erected in c. 1860.

Cultural / Ethnic Affiliation	1. N/A	2.	Associated Individuals	1. N/A	2.
Associated Events	1. N/A	2.	Architects / Engineers	1. N/A	2.
Builders	1. N/A	2.			

**MAJOR BIBLIOGRAPHICAL REFERENCES**Jones, Jim. Railroads of West Chester 1831 to the Present. Privately Printed, 2006.**PREVIOUS SURVEY, DETERMINATIONS**

Westtown Train Station included in the Chester County Historic Sites Survey as Thornbury Township Historic Site #011, 1979.

**EVALUATION** (Survey Director/Consultants Only)

Individual NR Potential: \_\_\_ Yes \_\_\_ No Context(s):

Contributes to Potential District X Yes \_\_\_ No District Name/Status: Westtown Train Station Historic District

Class: 2

Justification: The Township of Thornbury has deemed the West Chester and Philadelphia Railroad to have the potential to be eligible for inclusion on the National Register of Historic Places as a contributing resource to the Westtown Train Station Historic District; therefore, according to the Township's Historic Resource Classification Definitions, this resource is a Class 2.

**THREATS**Threats: 1 1. None 2. Public Development 3. Private Development 4. Neglect 5. Other

Explain:

<b>SURVEYOR INFORMATION</b>			
Surveyor Name / Title	Jane E. Dorchester	Date	8/2009
Project Name	Thornbury Township VPP Historic Resource Inventory & Survey		
Organization	Jane E. Dorchester, Historic Preservation Consultant	Telephone	610-431-3737
Street and No.	19 S. Church St.		
City, State	West Chester, Pa.	Zip Code	19382
Additional Survey Documentation			
Associated Survey Codes	PHMC Key #022604 & #155412		

**PENNSYLVANIA HISTORICAL RESOURCE SURVEY FORM – NARRATIVE SHEET 89C**

Pennsylvania Historical and Museum Commission, Bureau for Historic Preservation

Survey Code/HR #	66-091a, -091b, 091c, -091d, 66-151, & 66-152	Tax Parcel / Other No.	66-2-17-E; 66-2-27-E; 66-2-57-E
County	Chester 029	Municipality	Thornbury Township
Address	N/A	Historic / Other Name	West Chester & Philadelphia Railroad

**PHYSICAL DESCRIPTION:**

The West Chester and Philadelphia Railroad (WC&P) in Thornbury Township consists of seven resources, the Westtown Train Station, a two hole privy next to the station, two railroad bridges, and three sections of railroad track. The railroad enters the township from the east, just south of Westtown Road, crosses over Dilworthtown Road, Westtown-Thornton Road, and Goose Creek, and tunnels under State Route #926 before leaving the township heading north towards the Borough of West Chester just west of Westtown-Thornton Road.

The Westtown Train Station (HR #091a on Tax Parcel #66-2-17-E) is a four-bay, two-and-a-half story, double-pile, side-gable, wood frame building that faces east. It has a two-bay, two-story, double-pile, frame wing attached to its south elevation. It has two one-story, frame porches, one is a wrap-around porch on the east, north, and west elevations and the other one is located on the south elevation. The wrap-around porch once sheltered passengers waiting for the train. There is a two-hole, frame privy located to the south of the train station.

The Goose Creek Railroad Bridge (HR #091b on Tax Parcel #66-2-17-E) is a single-span, steel through girder bridge with concrete abutments. It spans Goose Creek.

The Westtown-Thornton Railroad Bridge (HR #091c on Tax Parcel #66-2-17-E) is a single-span, steel through girder bridge with stone and concrete abutments. It spans Westtown-Thornton Road.

Three sections of the WC&P railroad tracks are located in Thornbury Township. They are located on three different tax parcels, HR #091d is located on Tax Parcel #66-2-17-E, HR #151 is located on Tax Parcel #66-22-27-E, and HR #152 is located on Tax Parcel #66-22-57-E. Because these three sections of track are on three separate tax parcels, they have been counted as three separate resources on the 2008-2009 Historic Resource Inventory Update. These tracks are standard steel tracks with wood crossties.

**PENNSYLVANIA HISTORICAL RESOURCE SURVEY FORM – NARRATIVE SHEET 89C**

Pennsylvania Historical and Museum Commission, Bureau for Historic Preservation

Survey Code/HR #	66-091a, -091b, 091c, -091d, 66-151, & 66-152	Tax Parcel / Other No.	66-2-17-E; 66-2-27-E; 66-2-57-E
County	Chester 029	Municipality	Thornbury Township
Address	N/A	Historic / Other Name	West Chester & Philadelphia Railroad

**HISTORICAL NARRATIVE** (including a brief statement of significance for Class 2 properties only):  
The West Chester and Philadelphia Railroad (WC&P) was incorporated in 1848 in order to run a line from Philadelphia to West Chester through Delaware County; however, it was not until 1854 that train service began between Philadelphia and Media. By the end of 1858, the trains were running straight through to West Chester. The Westtown Train Station was erected in c. 1860. It also housed the Westtown Post Office. Due to increases in freight and passenger service, the station was expanded in c. 1879. In the same year, the WC&P bought out its rival, the West Chester Railroad. In 1881, the Pennsylvania Railroad (PRR) bought out the WC&P. The PRR ran train service on the WC&P line from 1881 until 1966 when the Southeast Pennsylvania Transportation Authority (SEPTA) took over the local train lines of the PRR. SEPTA ran the trains to West Chester until 1986. The eastern half of the old WC&P is still run as the R3 line of SEPTA. Today, the West Chester Railroad Company operates excursion trains on the line from West Chester to Glen Mills.

**STATEMENT OF SIGNIFICANCE:**

The West Chester and Philadelphia Railroad is significant because it led to the first wave of suburban development in the Township of Thornbury. Wealthy Philadelphians looking for suitable land to develop their country estates were introduced to Thornbury via the railroad. What they found were prosperous farms located in open, rolling countryside that was conveniently located near the thriving county seat of West Chester and within easy traveling distance from Philadelphia. From 1860 through the 1890s, important Philadelphians including Samuel J. Sharpless, John Wyeth, James Gay Gordon, John R. Penrose, and Thomas Dallett bought up the farms in Thornbury and turned them into “gentlemen stock farms” with such names as Lenape and Rokeby.

The railroad itself has retained a remarkable degree of integrity. Virtually no alterations have been made to it since its heyday. The only changes that have been made have been due to maintenance, some of which has been long overdue, and routine repairs.

# PENNSYLVANIA HISTORICAL RESOURCE SURVEY FORM – PHOTOGRAPH SHEET

Pennsylvania Historical and Museum Commission, Bureau for Historic Preservation

Survey Code/HR #	66-091a, -091b, 091c, -091d, 66-151, & 66-152	Historic / Other Name	West Chester & Philadelphia Railroad
Photographer	J. Christopher Lang	Date	4/19/2007



North and West (back) Elevations, Westtown Train Station

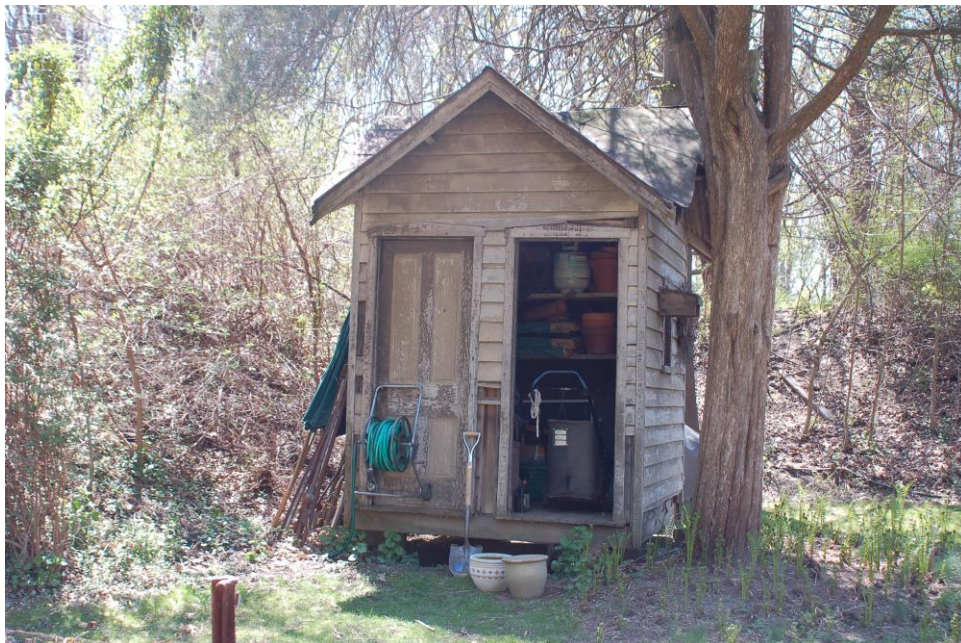

South Elevation, Privy

**PENNSYLVANIA HISTORICAL RESOURCE SURVEY FORM – PHOTOGRAPH SHEET**

Pennsylvania Historical and Museum Commission, Bureau for Historic Preservation

Survey Code/HR #	66-091a, -091b, 091c, -091d, 66-151, & 66-152	Historic / Other Name	West Chester & Philadelphia Railroad
Photographer	J. Christopher Lang	Date	4/19/2007



South Face, Goose Creek Railroad Bridge



South Face, Westtown-Thornton Railroad Bridge

**PENNSYLVANIA HISTORICAL RESOURCE SURVEY FORM – PHOTOGRAPH SHEET**

Pennsylvania Historical and Museum Commission, Bureau for Historic Preservation

Survey Code/HR #	66-091a, -091b, 091c, -091d, 66-151, & 66-152	Historic / Other Name	West Chester & Philadelphia Railroad
Photographer	J. Christopher Lang	Date	4/19/2007



West Chester & Philadelphia Railroad Tracks, looking South from Westtown Train Station