

THORNBURY TOWNSHIP ZONING MAP

CHESTER COUNTY, PENNSYLVANIA

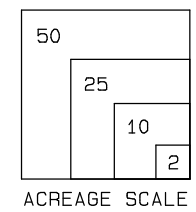
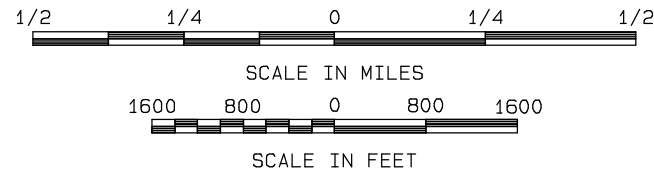
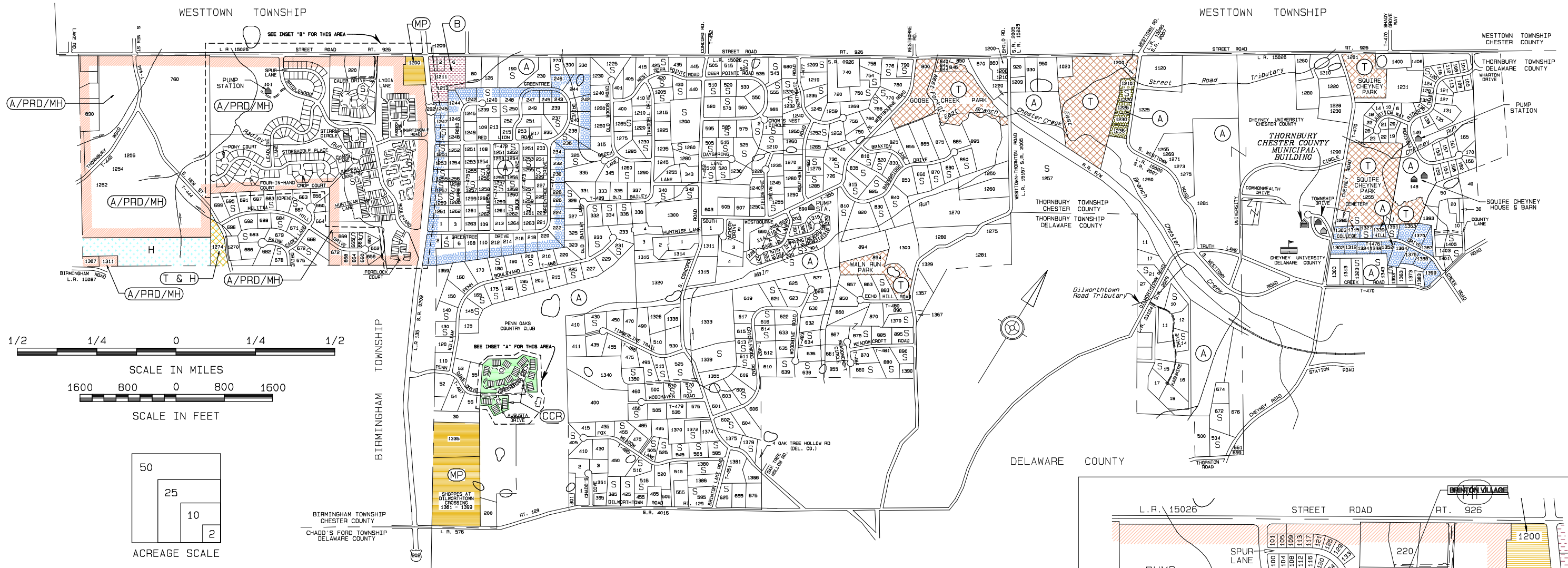

LEGEND

- A/PRD/MH - RESIDENTIAL/PLAN RESIDENTIAL DEVELOPMENT/MOBILE HOME
- T - TOWNSHIP OWNED PROPERTY
- A - AGRICULTURAL/RESIDENTIAL (80,000 SQ.FT., LARGE LOT)
- A - AGRICULTURAL/RESIDENTIAL (40,000 SQ.FT., SMALL LOT)
- B - BUSINESS
- H - HISTORICAL DISTRICT
- CCR - COUNTRY CLUB RESIDENTIAL
- MP - MULTIPURPOSE DISTRICT
- PUBLIC ROAD
- PRIVATE ROAD OR DRIVE
- 100 PROPERTY ADDRESS
- STREAM
- POND
- S SWIMMING POOL
- TOWNSHIP BOUNDARY LINE

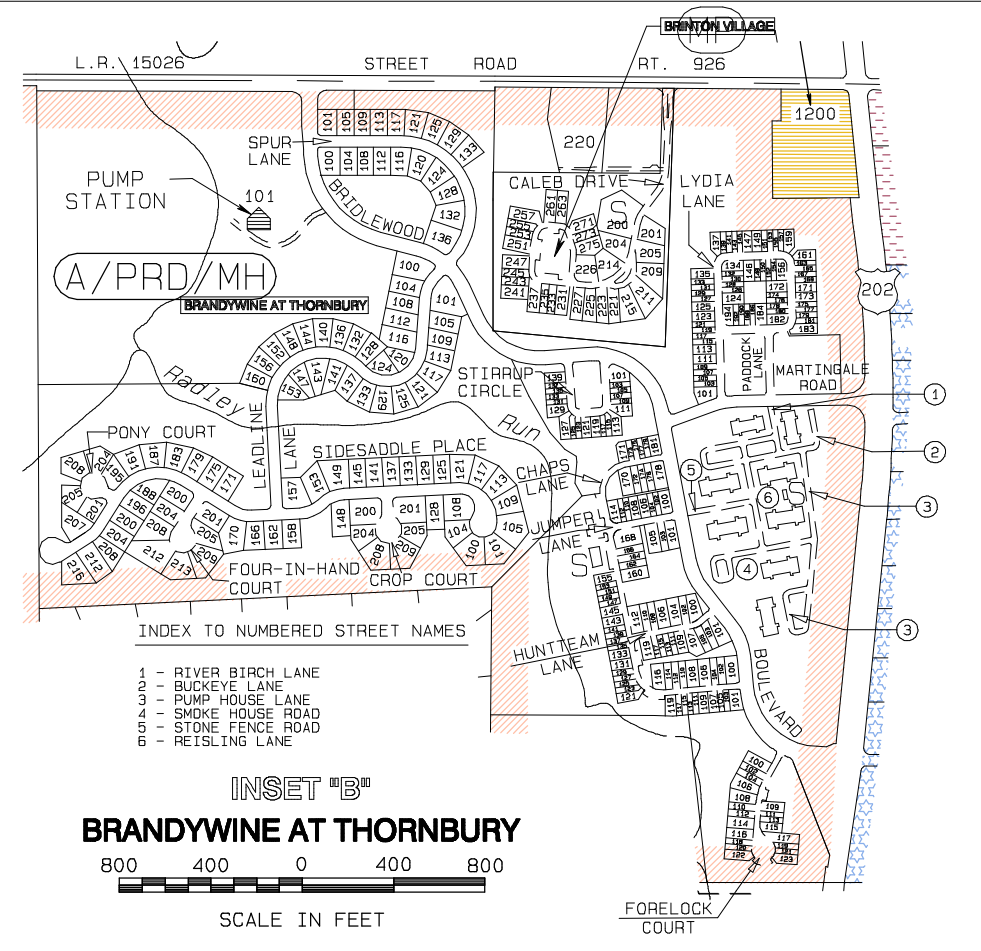
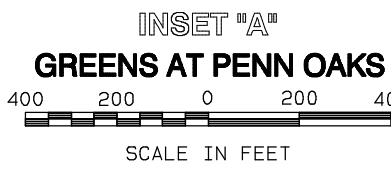
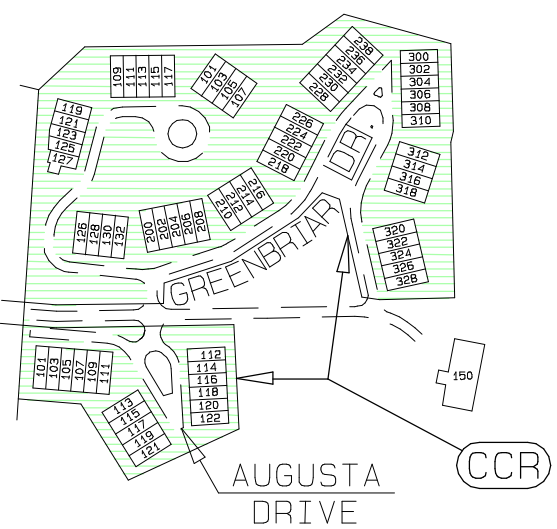

NOTES:

1. Refer to Township Flood Plain Ordinance and flood plain map for permissible building areas near flood plains.
2. Refer to PRD Ordinance for mobile home limitations.
3. Map prepared from a CAD file by GEO-Technical Services, Inc. last updated 11-18-91 from the most currently approved site development plans and authorized revisions by Thornbury Township; from the most current plat maps of Thornbury Township by the Chester County Board Assessment Appeals and other sources.
4. This plan is as up to date as possible at the time of printing.

MAP UPDATE AS OF 05-10-16 PREPARED BY:
YERKES ASSOCIATES, INC.
 CONSULTING ENGINEERS • LAND SURVEYORS
 1444 PHOENIXVILLE PIKE, P.O. BOX 1568
 WEST CHESTER, PA. 19380
 (610) 644-4254